

## Why Priors?

The field in question is agricultural land and so is suitable for growing.

There is a lot of new housing in this area and no CBC allotment provision for residents who want to grow food.

The land is not located immediately adjacent to houses.

The land is owned by the Council but is not currently being used. It costs a lot less for the Council to develop allotments on land it already owns, than have to purchase land.

## Concerns you may have

Some people might be worried about loss of access to the field. There are no plans to restrict access for walkers along public rights of way (see plan).

Please use the postcard provided or e-mail us to let us know your views and any issues that ought to be taken into consideration.

**You can come and meet council staff to discuss the proposal at Priors Pavilion from 3pm to 7pm on Thursday 8<sup>th</sup> August.**

## Why you might be in favour

You might be interested in having a plot or support local food-growing initiatives. You might be on a waiting list already and keen to see the Council increase the provision of plots in the Borough.

Allotments score highly in terms of bio-diversity and sustainability. They can also benefit those who work them: home-grown vegetables, fresh air and exercise, new friends...

## Next Steps

Notices about the proposal will be in The Echo on 9<sup>th</sup> & 16<sup>th</sup> August.

If you want to support or object to the proposal, you can use the postcard, e-mail us or use an on-line form: [www.cheltenham.gov.uk/info/510/allotments](http://www.cheltenham.gov.uk/info/510/allotments)

If planning permission is later sought, you would be able to support or object to the plans again during the planning application process.

.....  
**Cheltenham Borough Council**  
Green Space Development Team  
Central Depot  
Swindon Road  
Cheltenham  
GL51 9JZ  
Email: [allotments@cheltenham.gov.uk](mailto:allotments@cheltenham.gov.uk)



## Allotments

**Information about a proposal for allotments on land at Prior's Farm**

## Background

There has been a high demand for allotments in Cheltenham for several years and the Council is looking at possible locations for a new site.

A piece of land at Prior's Farm (see map) may be suitable but we want to get public opinion before deciding whether to explore this option further.

Please take a look at the map and the proposal and let us know your thoughts using the form enclosed.

## What is proposed?









If the feedback shows demand for plots in this area, the Council would look to earmark the land and develop part of it (perhaps 50 plots).

Further development of plots would depend on future demand.

A driveway would be opened up (as shown) and the allotment area would be fenced where required. Existing hedges could also act as boundaries.

Public rights of way would be protected so that dog walkers and recreational walkers could continue to use the area as they do now.

## Proposal Plan

	Existing access track		Access gates
	Informal walk ways		New hedgerow in front of proposed chain link fence
	Proposed parking		Public right of way
	6 ft chain link fencing inside existing hedgerow		Proposed pedestrian access via bridge

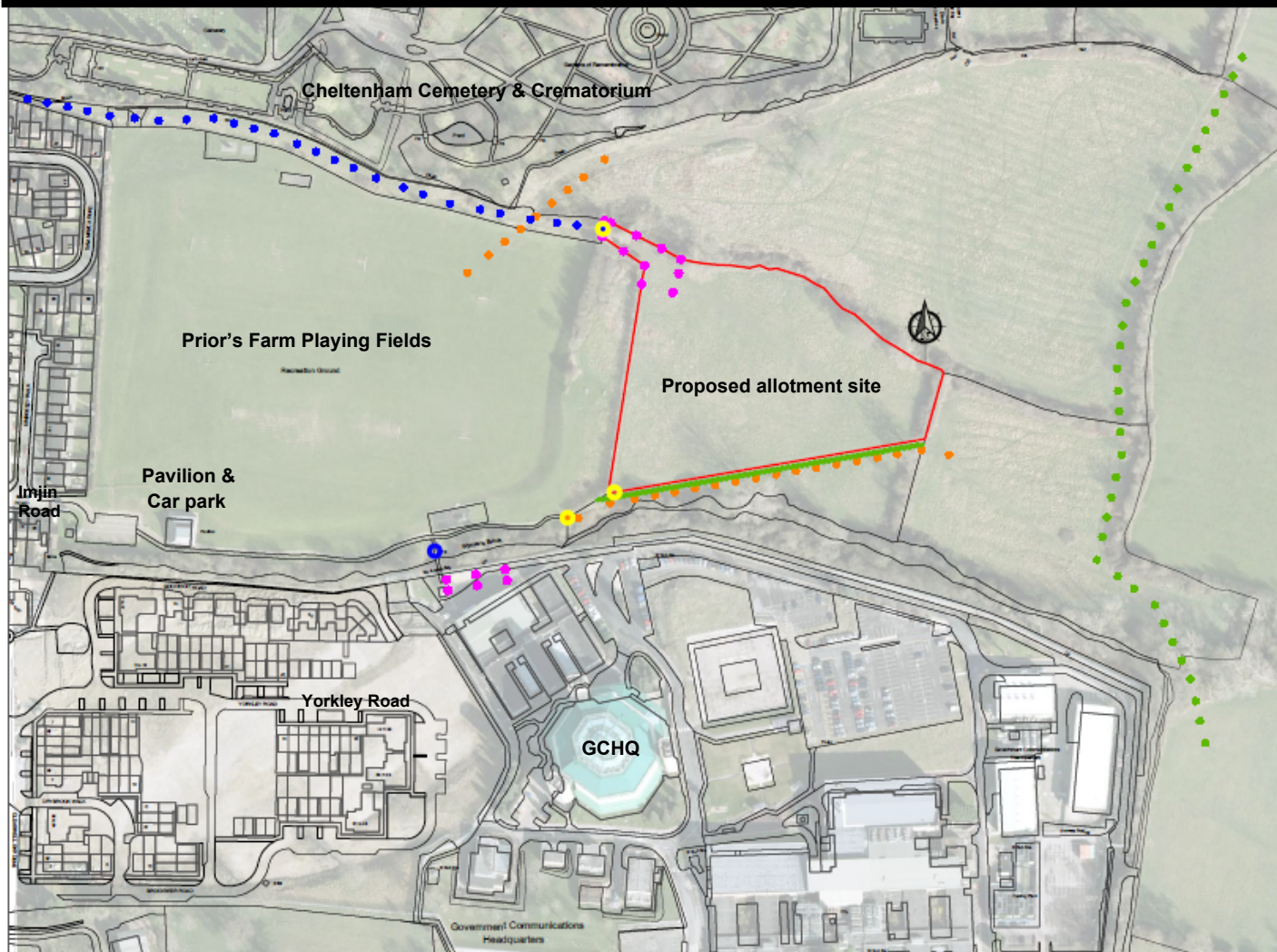

NOT TO SCALE